

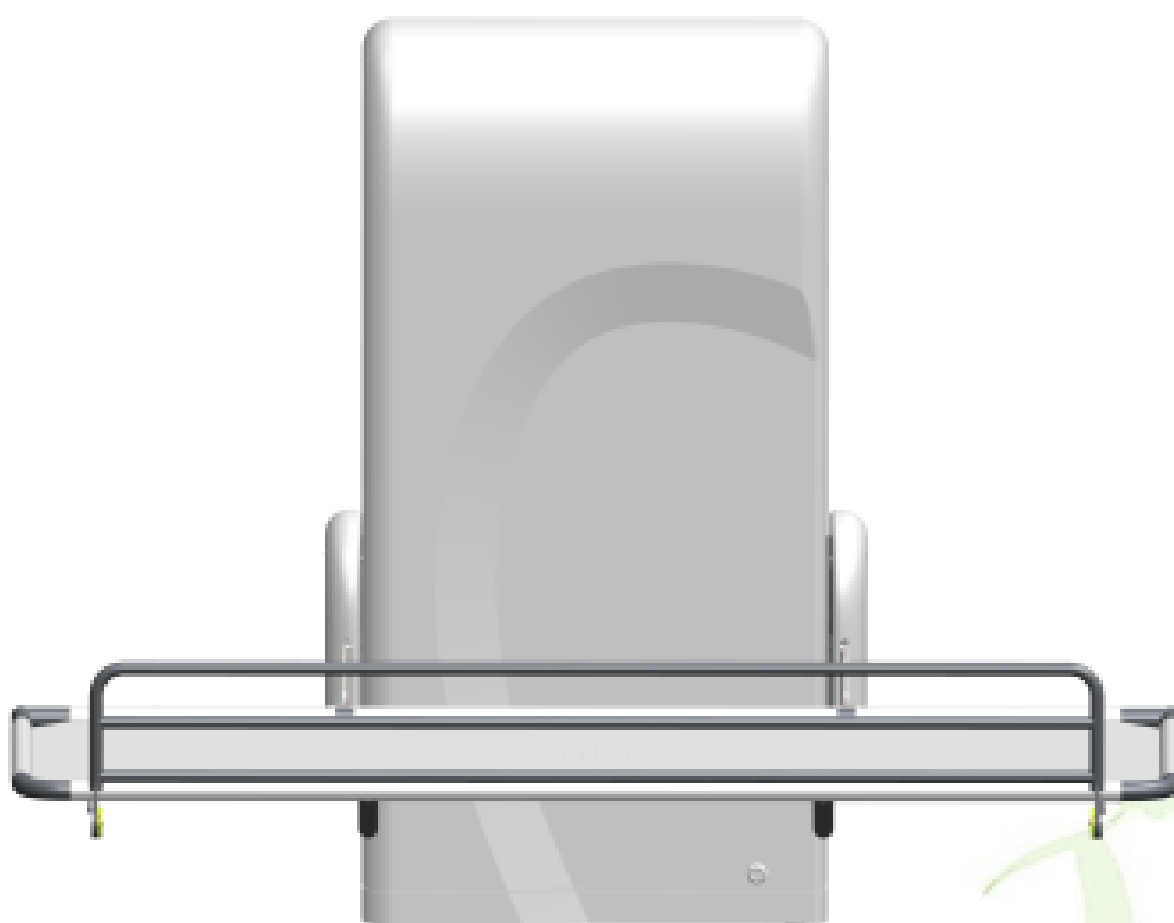

# Nivano CTE2 Owner's Manual and Installation Instructions

Shower & Changing Table

USA Version



**Important: Read this manual before use**





## Contents

<b>Safety information</b>	<b>3</b>
<b>Technical data</b>	<b>4</b>
<b>Instructions for use</b>	<b>5</b>
<b>Using the side guard &amp; headrest</b>	<b>6</b>
<b>Installation and fixing</b>	<b>7</b>
<b>Installation using the adapter plate</b>	<b>8</b>
<b>Installation Dims and Cleaning</b>	<b>9</b>
<b>Troubleshooting</b>	<b>10</b>

Our policy is one of continuous development, and we therefore reserve the right to make technical alterations without notice. The content of this publication may not be copied either whole or in part without the consent of Astor Bannerman.



## WARNING:

Before installing or using this equipment you must read and fully understand these instructions.

Thank you for purchasing a CTe2 Changing Table.

The CTe2 height adjustable changing table is intended for showering and changing children and adults weighing up to safe working load (SWL) marked on the equipment. The changing table must not be used for any other purpose.

SWL is 330 lbs for Standard Model

SWL is 484 lbs for uprated model (2 support tubes under bed)









## Product Description.









The height adjustable changing table is powered by a 24 volt direct current control system with battery backup. This is to enable the use of the changing table in the event of mains electrical supply failure. It is essential that the mains electrical power is switched on at all times to charge the backup batteries.

## Warranty.

This product is guaranteed against all defects in manufacture for a period of one year. This does not effect your statutory rights.

## Labels:

Model: CTe2		
		
Lift range: 24"		
SWL 330 lbs		
Max: 1 Person		
		
110V ~ 50Hz 250W		
IP X4		
		
		
Made in England by:		
Astor Bannerman (Medical) Limited		
11f Coln Park industrial estate		
Andoversford		
GL54 4HJ		LB35

Model: CTe2		
		
Lift range: 24"		
SWL 484 lbs		
Max: 1 Person		
		
110V ~ 50Hz 250W		
IP X4		
		
		
Made in England by:		
Astor Bannerman (Medical) Limited		
11f Coln Park industrial estate		
Andoversford		
GL54 4HJ		LB35

## Technical Data



### Electrics.

A.C. Input 110V~, 50Hz, 650W Maximum.

D.C. Output, 24v, 6 Amps Maximum.

Duty cycle 10%. maximum: 2 mins on & 18 mins off.

### Misc.

- Product weight (Dry): 154 lbs
- Maximum user weight: (2 Models) 330/484 lbs
- 'A' weighted sound emission: <70dB(A)

### Transport and storage.

- Ambient temperature range: 41°F to 158°F 10 - 80% not condensed at 68°F 50kPa to 106kPa
- Relative humidity range:
- Atmospheric pressure range:

### Recycling.

- Battery: Recyclable. Not for disposal. Environmental danger
- Packaging: Wood and corrugated cardboard, recyclable
- The product: Electrical components, batteries, steel and plastic parts to be separated and recycled to local requirements.

### Product dimensions.

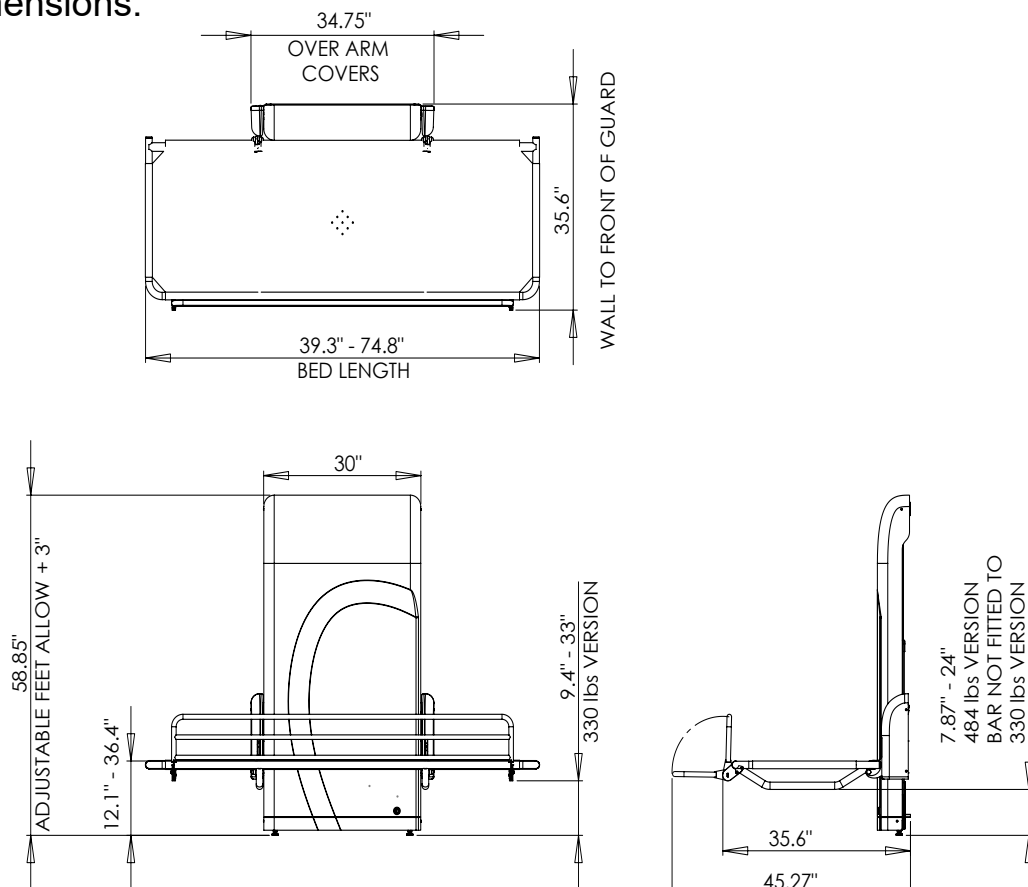

**Carry out the following checks daily before using the changing table.**

Check the weight of the client and ensure the machine is rated for the weight to be lifted.

Check the electricity supply is connected and turned on.

Check there are no obstructions or items that may be trapped when the changing table is operated.

Check the changing table will raise and lower properly using the handset. Check the bed retaining catch is working.

**Instructions for use.**

Before use check that the changing table will lift and lower using the handset.

**Adjusting the height of your changing table**

The changing table is operated with a hand control. Pressing one of the buttons will either raise or lower the changing table as required.

Position the table at a convenient height to transfer the client.

**Using the bed**

Hold the top of the bed and rotate the bed forward into a horizontal position.

To stow the bed simply rotate the bed upwards until the bed is parallel with the cover, the gas springs will stop the bed from falling forward.



## Using the front guard & Headrest

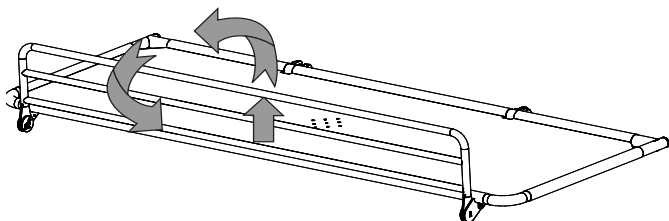

### Stowing the Guard.

Lift the guard upwards, pull and rotate towards you and then lower it until under the bed. It will then lock in the stowed position.

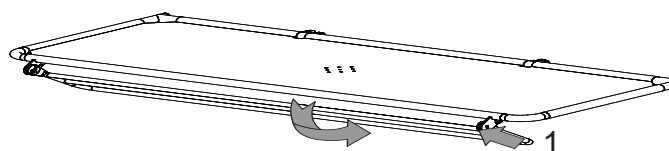
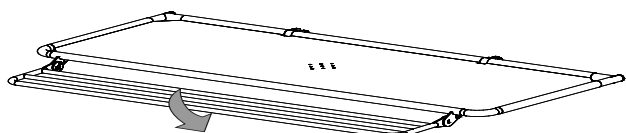

### Deploying the Guard.

To deploy the guard, lift in the direction of arrow 1, rotate the guard up into position and it will drop into the locked position.

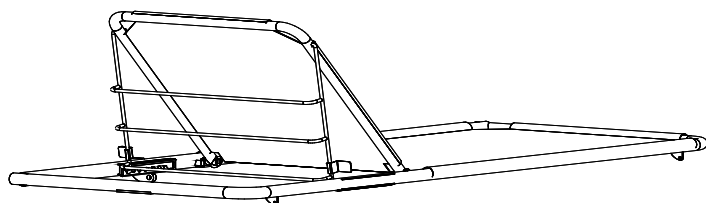

### Using the bed with Headrest.

Before transferring the patient to the bed, lift the headrest up and ensure the support bar is secure and will not slip when the patient leans against it. If the headrest is no longer needed, the patient should sit forward and not lean on the headrest as it is lowered.

**Ensure the wall is strong enough to support the unit  
(220 lbs per fixing)**

1: Position the frame against the wall and mark 4 positions for the retaining fixings  
(Not supplied).

2: Remove the frame and drill the 4 fixing holes.

Reposition the frame and secure to the wall using suitable fixings.

**NOTE:** Plastic wall plugs are not suitable for fixing the unit.



1

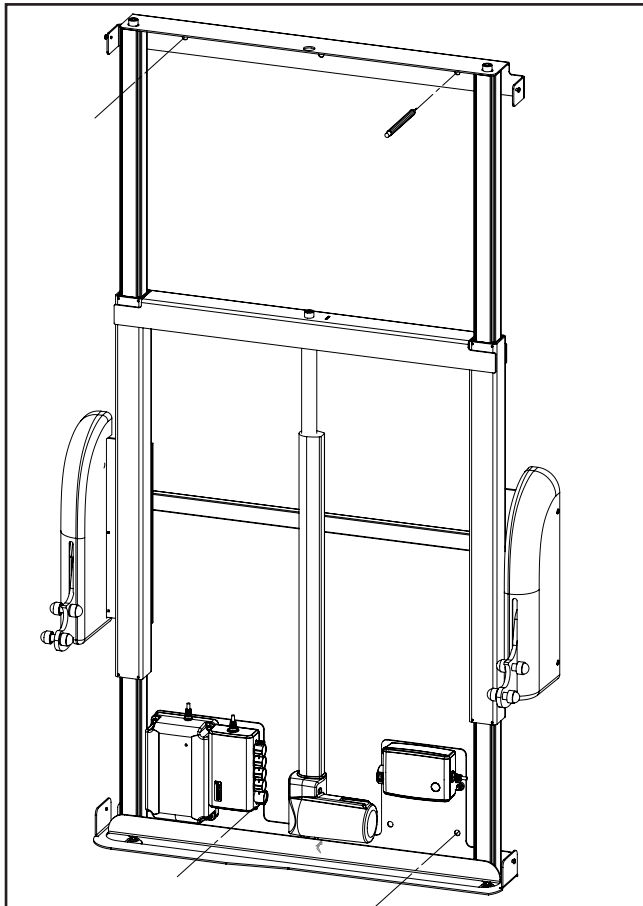

2

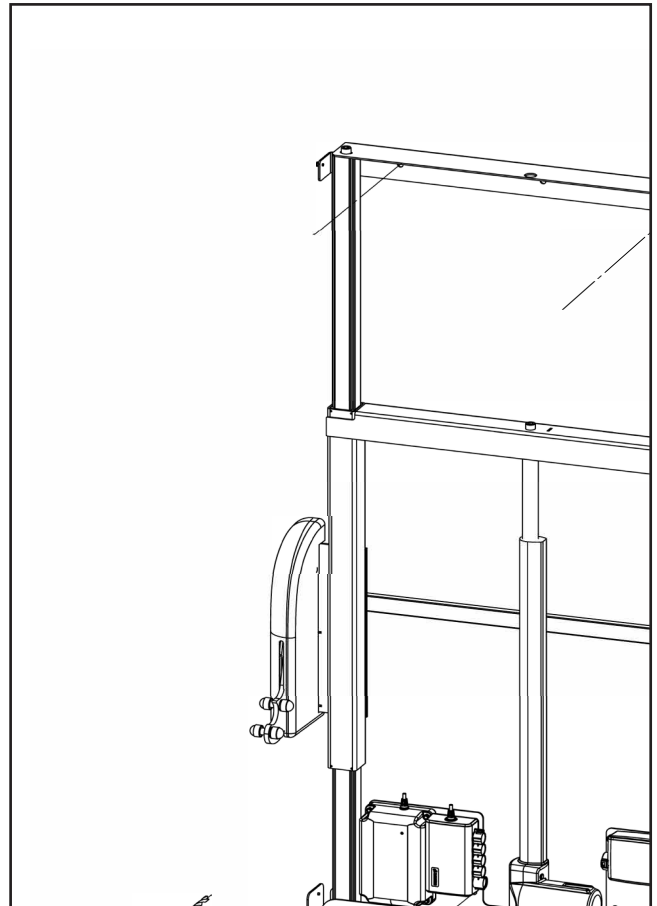

### Fitting the Stretcher

Align the stretcher mounting bracket holes with the support arms and secure using the shoulder bolts, nuts and washers supplied; torque to 10Nm.

Fit the white plastic covers

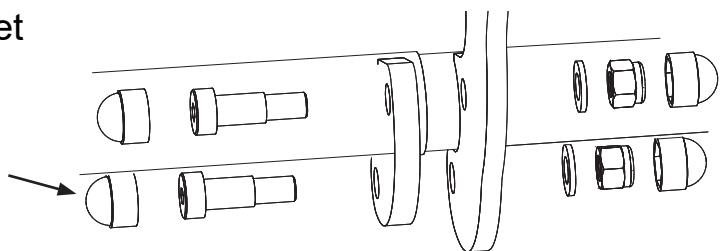



Ensure the wall is strong enough to support the unit (220 lbs per fixing).  
**NOTE:** Plastic wall plugs are not suitable for fixing the unit.



The adapter plate is to be used where the previous version of the CTe has been previously installed or the site has been prepared for the previous CTe, but a CTe2 is going to be installed.

**Note 1:** Position the Adapter Plate (Item 1) against the wall, aligning the holes in the plate with the existing holes from the original CTe fixing position. Use the appropriate fixings for the type of wall in these 2 positions.

**Note 2:** Place the frame onto the 2 off studs on the adapter plate. Fit M8 Nuts and washers loosely to hold the frame in place.

**Note 3:** The 2 off original holes will need to be filled (if already drilled) as they are not used.

**Note 4:** Mark the 2 off positions for the lower fixing holes. Remove the frame from the wall and drill as appropriate for the fixings being used.

Reposition the frame and secure to the wall using suitable fixings.

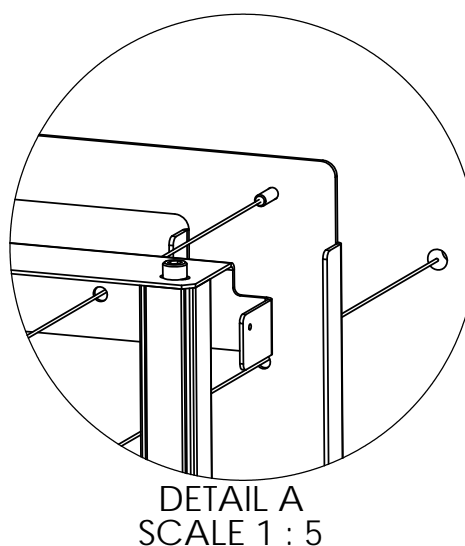
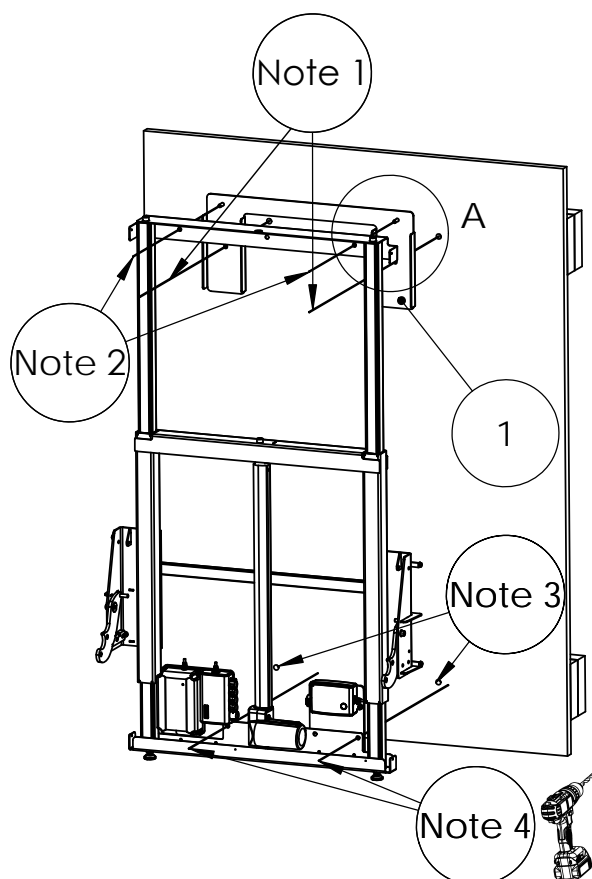

# Installation Dimensions and Cleaning



## CTe2 Changing Table

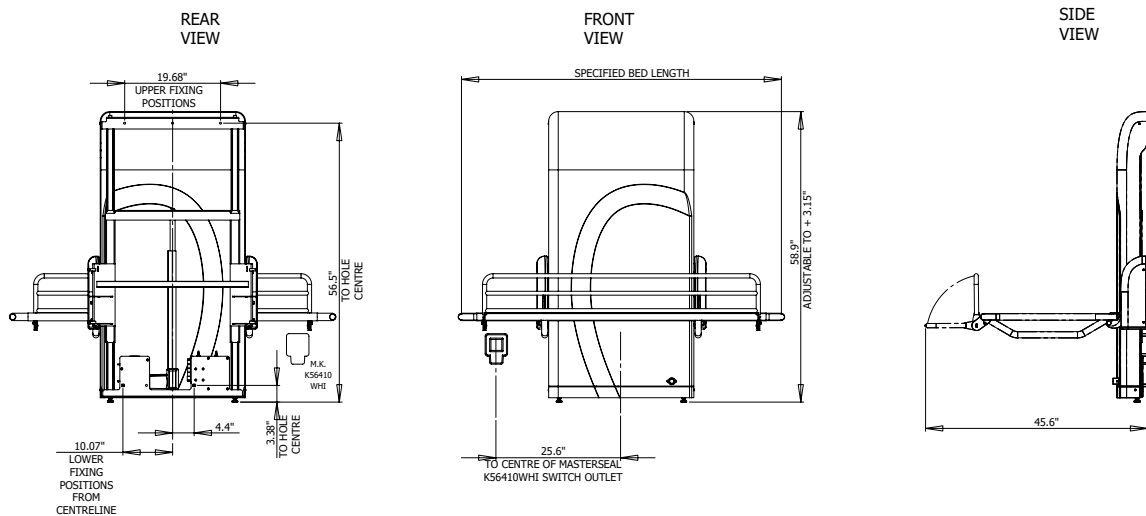

### Electrics

A 110 volt 1.25kW Waterproof switched flex outlet must be provided in the specified position shown, supplied from a protected fused spur. (Can be either side of bed.)

### Fixing

The changing table fixes to the wall and rests on the floor.

The wall must be load bearing and strong enough to bear a load of 220 lbs on each of the wall fixings.

The wall must be flat and free from obstructions of floor level to 60" above the floor.

There should be a minimum clearance of 1.5" at each end of the bed.

If the changing table is to be mounted on a stud wall it will need special reinforcement, either

1. 4"x4" Noggins fixed into the wall with screws (NOT Nailed).

2. OR:-Faced with Marine or exterior grade plywood 1" thick (MINIMUM), secured every 8", covering the entire fixing area

60" high and as long as the specified bed length, equal about the centreline. It must be in contact with and supported by the floor.

**This unit CANNOT be fitted to (Gypframe) metal frame or similar type stud wall unless it has been fully reinforced with timber struts that are secured top and bottom and then reinforced with noggins or 1" plywood screwed in place (not nailed)**

The information above is available as a separate document.

## Cleaning

### Cleaning

The changing table may be cleaned using most mild cleaning agents. Chemical agents and solvents must not be used, i.e. drain cleaners, acetone, oven cleaners or acids.

The changing table should be cleaned using a warm soapy solution and rinsed off, then dried with a soft cloth.

Attention should always be paid to instruction labels for the cleaning agent.

### Caution

The heavy use of oil based products may adversely affect the stretcher material. Oils and other petrochemical products should be avoided and any residue removed immediately.

These products include : Baby oil and emollient creams.

### Troubleshooting tips:

1. Pressing the handset results in no movement of the equipment:

Check the mains power is connected and switched on. Check handset is plugged in correctly.

2. Pressing the buttons on the handset results in the machine trying to move, but fails to operate correctly:

Check mains power is connected and switched on.

3. Guard will not stay locked in position and/or is difficult to use:

The mechanism has been damaged during use.

4. Stretcher will not stay upright and/or is difficult to lift into position:

The lifting gas strut has failed.

If issues 1 and 2 are not solved by checking as described, please call Technical Support for assistance.

If you experience issues 3 or 4 please call Technical Support for Assistance.

Astor-Bannerman Technical Support:

Tel: 01242 822972

Email: [support@astorbannerman.co.uk](mailto:support@astorbannerman.co.uk)



**Astor-Bannerman Ltd  
The Elephant Works,  
Andoversford Link, Andoversford,  
Cheltenham,  
Gloucestershire, GL54 4LB**

**Email: [sales @astorbannerman.co.uk](mailto:sales@astorbannerman.co.uk)  
Tel: +44 (0) 1242820820  
Fax: +44 (0) 1242821110**

**Technical Helpline: +44 (0) 1242 922972**

